

nedis

## Wireless HDMI™ Extender

Article number: VTRA3470AT



Nedis BV  
De Tweeling 28, 5215 MC 's-Hertogenbosch, The Netherlands 07/22

## Preface

Thank you for purchasing the Nedis VTRA3470AT.

This document is the user manual and contains all the information for correct, efficient and safe use of the product.

This user manual is addressed to the end user. Read this information carefully before

- installing or using the product.
- Always store this information with the product for use in the future.

○  
○

## Product description

○  
○

## Intended use

○  
○

The Nedis VTRA3470AT is a wireless HDMI extender that transfers HDMI signals from source device(s) to display and/or audio device(s).

In SW mode the product is a switch: multiple senders (up to 4 - not included) can be connected.

In SP mode the product is a splitter: multiple receivers (up to 4 - not included) can be connected.

The included infrared transmitters and receivers transfer infrared signals between the transmitter and receiver.

This allows you to use the remote control of your source device while in range of the receiver.

This product is intended for indoor use only.

The product is not intended for professional use.

## Specifications

<b>Product</b>	Wireless HDMI™ Extender
<b>Article number</b>	VTRA3470AT
<b>Transmitter</b>	HDMI in / HDMI out / IR out / USB / Audio in
<b>Receiver</b>	HDMI out / IR in / USB / Audio out
<b>Max. supported video format</b>	1920 x 1080 @60Hz
<b>Other supported video formats</b>	720p / 480p
<b>Supported audio format</b>	PCM 2ch
<b>HDCP</b>	HDCP 1.3
<b>Max. transfer rate</b>	1.65 Gbps
<b>Max. transfer distance</b>	150 m
<b>5GHz frequency range</b>	5180 - 5240 MHz
<b>Maximum transmission power</b>	10 dBm
<b>Infrared support</b>	30 - 60 KHz
<b>Operating temperature</b>	0 - 45 °C
<b>Operating humidity</b>	10 - 80 %
<b>Input power</b>	12 VDC ; 1.0 A

## Main parts (image **A**, **B** & **C**)

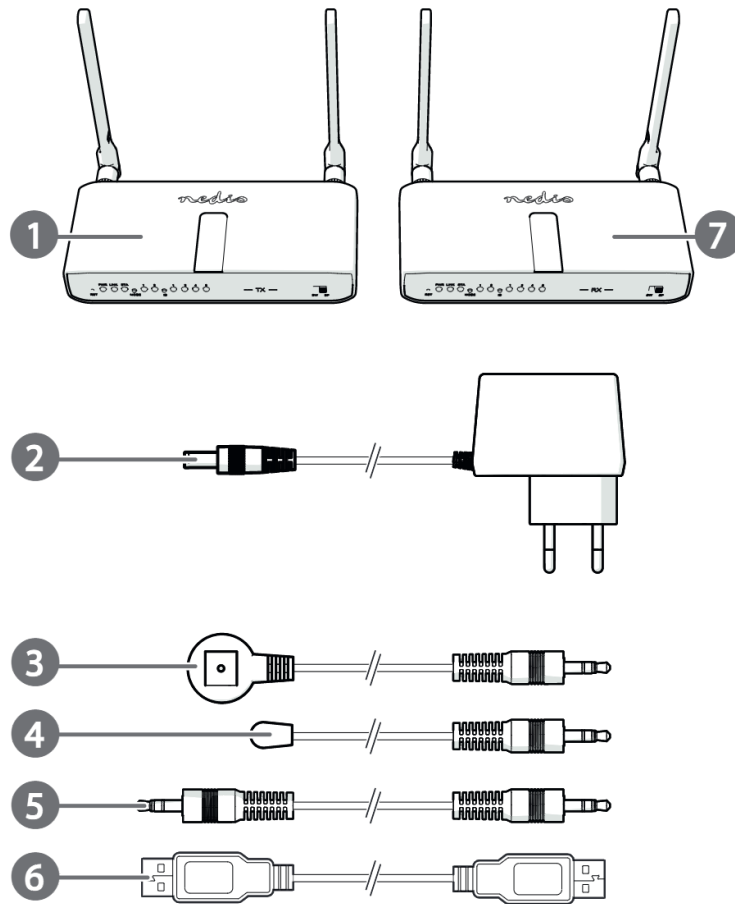

**A**

**1** Transmitter

**2** Power adapter (2x)

**3** Infrared transmitter

**4** Infrared receiver

**5** 3.5 mm audio cable

**6** USB cable

**7** Receiver

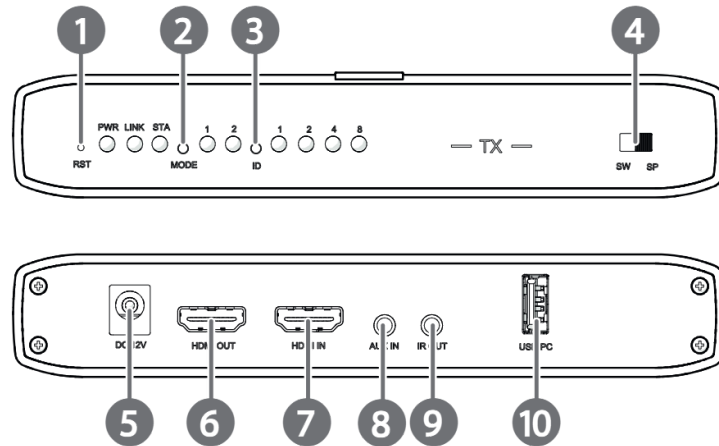
**B**

- 1 Reset button
- 2 Display mode button
- 3 Channel id button
- 4 Mode switch
- 5 Power supply port
- 6 HDMI out port
- 7 HDMI in port
- 8 AUX IN port
- 9 Infrared port
- 10 USB port

Receiver (image **C**)

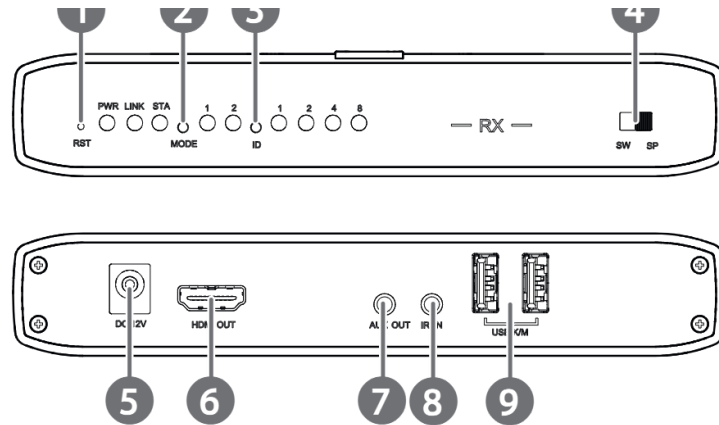

## C

① Reset button

② Display mode button

③ Channel id button

④ Mode switch

⑤ Power supply port

⑥ HDMI out port

⑦ AUX OUT port

⑧ Infrared port

⑨ USB ports

## Safety instructions

### ⚠ WARNING

- Ensure you have fully read and understood the instructions in this document before you install or use the product. Keep the packaging and this document for future reference.
- Only use the product as described in this document.

- Only use the provided power cable.
- Do not expose the product to water or moisture.
- Do not unplug the product by pulling on the cable. Always grasp the plug and pull.
- This product may only be serviced by a qualified technician for maintenance to reduce the risk of electric shock.

---

## Installation

---

### Check the contents of the package

Check that all parts are present and that no damage is visible on the parts. If parts are missing or damaged, contact the Nedis B.V. service desk via the website: [www.nedis.com](http://www.nedis.com).

---

### Connecting the product to a power source

1. Plug a power adapter **A2** into the power supply port **B5** of the transmitter **A1**.
2. Plug the other end of the power adapter **A2** into a power outlet.
3. Plug a power adapter **A2** into the power supply port **C5** of the receiver **A7**.
4. Plug the other end of the power adapter **A2** into a power outlet.

---

### Pairing the transmitter and receiver

1. Set the units **A1A7** to **SP** mode with the mode switches **B4C4**.
  2. Insert an HDMI cable into the HDMI in port **B7** of the transmitter **A1**.
  3. Insert the HDMI cable into the HDMI out port **C6** of the receiver **A7**.
- i** The link light keeps flashing until the pairing is complete.

---

### Connecting a source device to the transmitter

1. Insert an HDMI cable into the HDMI in port **B7** of the transmitter **A1**.
  2. Insert the other end of the HDMI cable into the HDMI port of your source device.
- i** Optional: connect an audio source to the AUX IN port **B8** of the transmitter **A1** with the 3.5 mm audio cable **A5**.
- i** Optional: connect a display device to the HDMI out port **B6** of the transmitter **A1**.

1. Insert an HDMI cable into the HDMI out port **C6** of the receiver **A7**.
2. Insert the other end of the HDMI cable into the HDMI port of your display.
- i** Optional: connect speakers to the aux out port **C7** of the receiver **A7**.

---

## Connecting infrared for remote control use

1. Insert the infrared transmitter **A3** into the infrared port **B9** of the transmitter **A1**.
- i** Make sure the infrared transmitter **A3** is aimed at the infrared sensor of your display.
2. Insert the infrared receiver **A4** into the infrared port **C8** of the receiver **A7**.
- i** Make sure your remote is aimed at the infrared receiver **A4**.

---

## Connecting a USB keyboard or mouse

1. Insert the USB cable of the input device to a USB port **C9** of the receiver **A7**.
2. Insert the USB cable **A6** into the USB port **B10** of the transmitter **A1**.
3. Insert the other end of the USB cable **A6** into a USB port of your source device.

---

## Use

---

### Setting the display mode

- i** The extender can be set to graphic mode or video mode.
- 1. Press the display mode buttons **B2C2** to switch between display modes.
- 2. Press and hold the display mode button **B2C2** to optimise signal transmission.

---

### Splitter mode

- i** Connect multiple receivers (not included) to the transmitter.
- 1. Set the units **A1A7** to **SP** mode with the mode switches **B4C4**.
- 2. Set the transmitter **A1** and the receivers **A7** to the same channel with the channel id buttons **B3C3**.

---

### Switch mode

- i** Connect multiple transmitters (not included) to the receiver
- 1. Set the units **A1A7** to **SW** mode with the mode switches **B4C4**.

**i** Switch between the different transmitters with the channel id button **C3**.

---

## Resetting the product

Press and hold the reset button **B1C1** for 6 seconds to restore the product to factory default settings.

---

## Maintenance

Clean the product regularly with a soft, clean, dry cloth. Avoid abrasives that can damage the surface.

Do not use aggressive chemical cleaning agents such as ammonia, acid or acetone when cleaning the product.

---

## Warranty

- - Any changes and/or modifications to the product will void the warranty. We accept no
  - liability for damage caused by improper use of the product.
  - This product is designed for private use (normal domestic use) only. Nedis is not
  - responsible for wear, defect and/or damages caused by commercial use of the product.
  -
- 

## Disclaimer

○

Designs and specifications are subject to change without notice. All logos, brands and product names are trademarks or registered trademarks of their respective owners and are hereby recognized as such.

---

## Disposal



This symbol indicates that this product should not be thrown away with other household waste throughout the EU. To prevent possible harm to the environment or human health by uncontrolled waste disposal, you are responsible for recycling it so that it can promote the sustainable reuse of raw materials. To return your used product, you



---

## Declaration of Conformity

We, Nedis B.V. declare as manufacturer that the product VTRA3470AT from our brand Nedis®, produced in China, has been tested according to all relevant CE standards and regulations and that all tests have been passed successfully. This includes, but is not limited to the RED 2014/53/EU regulation.

The complete Declaration of Conformity (and the safety datasheet if applicable) can be found and downloaded via:

[nedis.com/VTRA3470AT#support](https://nedis.com/VTRA3470AT#support)

- 
- 
- 
- 
- 
- 
- 
- 
- 
- 
-